

GERKIN WINDOWS & DOORS RESERVES THE RIGHT TO CHANGE OR DISCONTINUE MANUFACTURING ANY OF ITS STANDARD WINDOW SYSTEMS OR COMPONENTS WITHOUT PRIOR WRITTEN NOTICE.



5200 SERIES INSWING HOPPER WINDOW

SHEET NO:
1

5200 SERIES INSWING HOPPER WINDOW



GERKIN™
WINDOWS & DOORS

Phone: 402-494-6000 Email: gerkin@gerkin.com

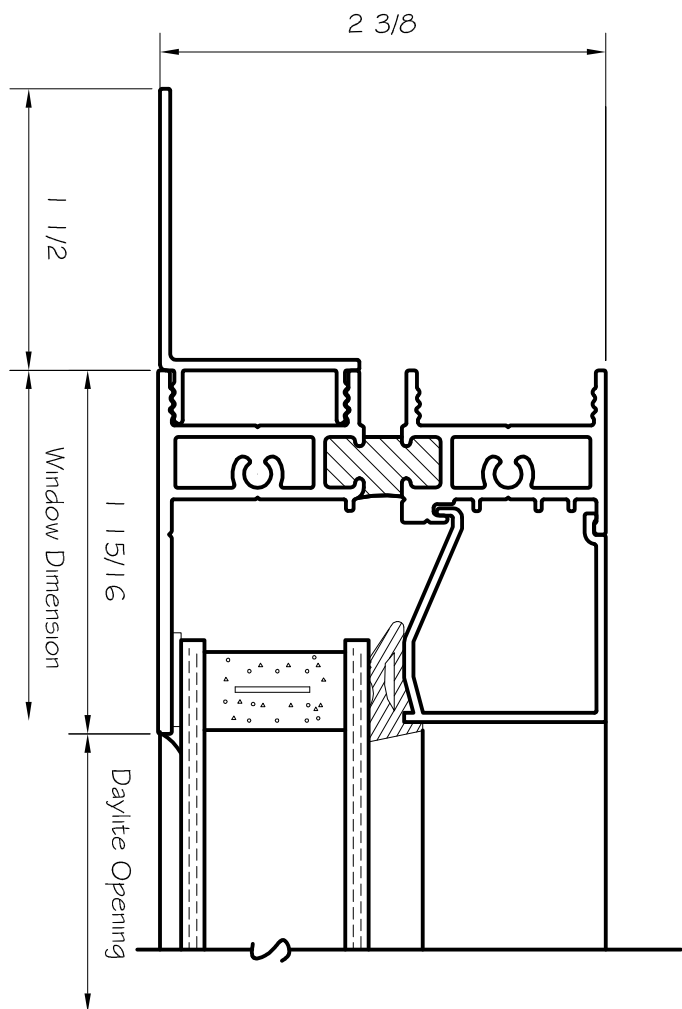

7 JAMB AT FIXED W/
OPTIONAL NAILING FLANGE

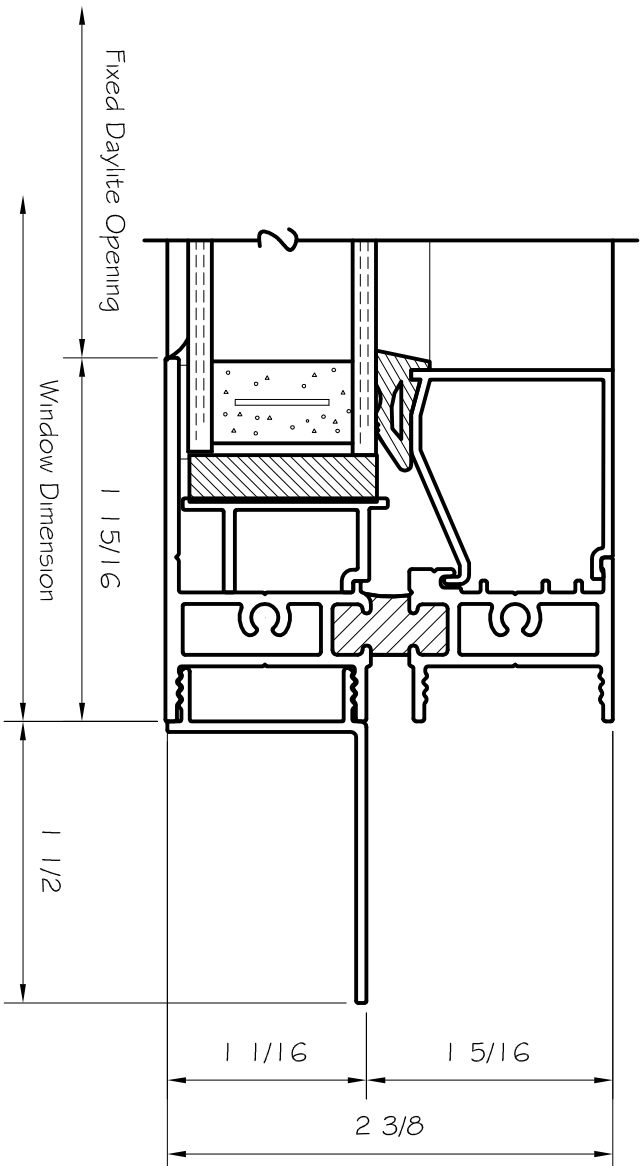

8 JAMB AT FIXED

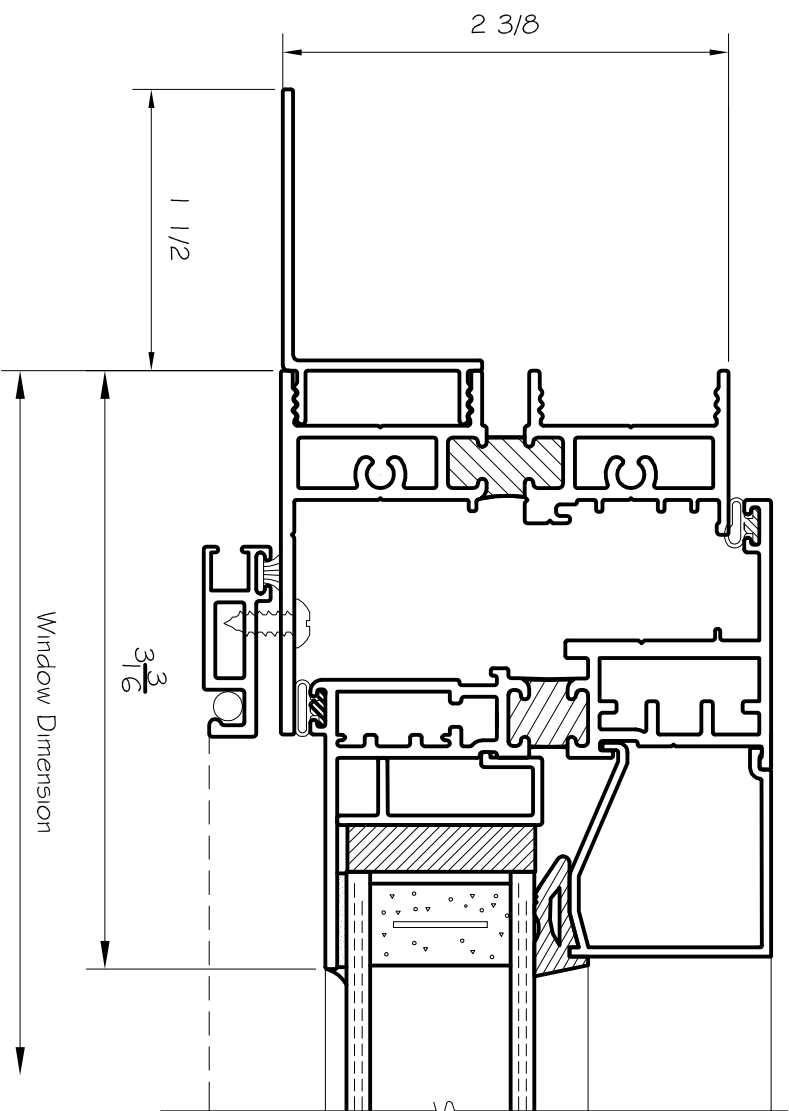

5 JAMB AT SASH W/
OPTIONAL NAILING FLANGE

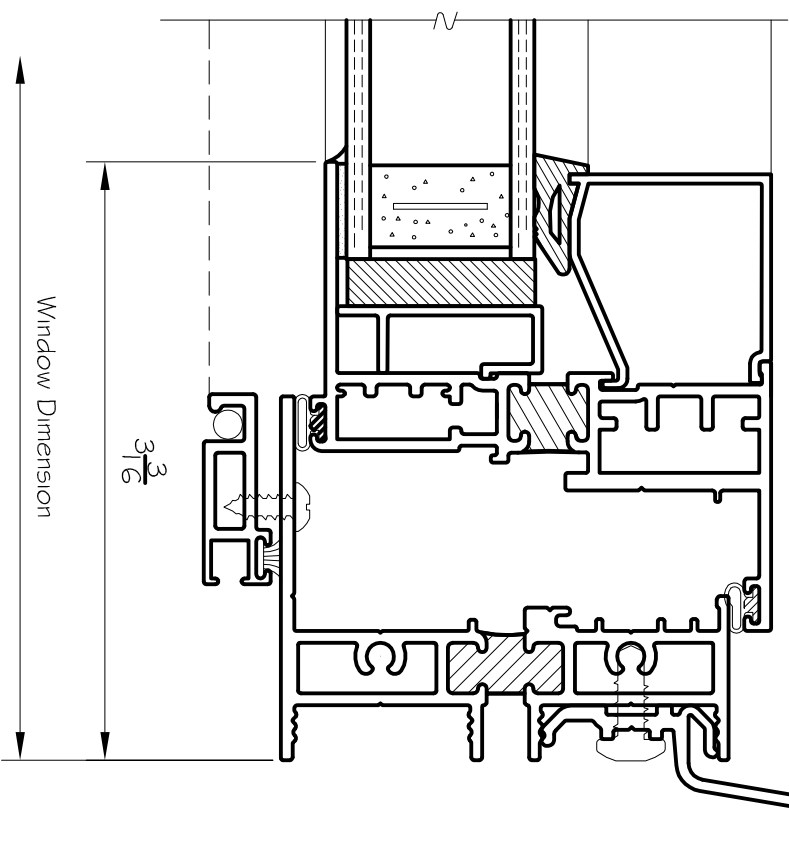

6 JAMB AT SASH W/
OPTIONAL STRAP ANCHOR