



## Gerkin Windows & Doors

P.O Box 3203

Sioux City IA. 51102

Phone: (402) 494-6000 (800) 475-5061

Fax: (402) 494-6765

Web site: [www.gerkin.com](http://www.gerkin.com) E-Mail: [gerkin@gerkin.com](mailto:gerkin@gerkin.com)



### Rhino series thermally broken aluminum windows Information book

- Page RC1 Sizing guidelines for 1-lite openings (All Rhino Windows)
- Page RC2 Sizing guidelines for multiple lites in 1 frame ( Awning, casement, fixed & hoppers)
- Page RC3 Sizing guidelines for multiple lite openings side-stacked with no structural mullions ( Awning, casement, fixed & hoppers)
- Page RC4 Sizing guidelines for multiple lite openings side-stacked with structural mullions ( Awning, casement, fixed & hoppers)
- Page RC5 Sizing guidelines for multiple sliders side-stacking ( Rhino sliding windows)
- Page RC6 Sizing guidelines for sliders with head-staking ( Rhino sliding windows)
- Page RC7 Sizing guidelines for multiple singlehung side-stacking ( Rhino singlehung windows)
- Page RC8 Sizing guidelines for singlehung with head-staking ( Rhino singlehung windows)
- Page RC9 Accessories Gerkin panning system (All Rhino windows)
- Page RC10 Accessories Gerkin subframe system (All Rhino windows)
- Page RC11 Accessories Miscellaneous pieces (All Rhino windows)
- Page RC12 Warranty (All Rhino windows)



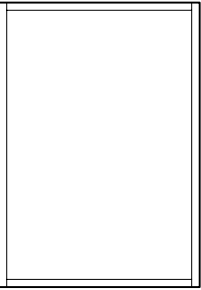

5500  
FIXED

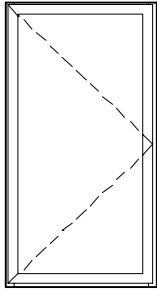

5300  
CASEMENT

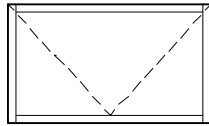

5200  
HOPPER

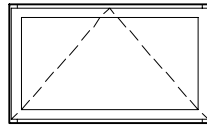

5100  
AWNING

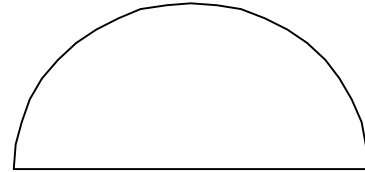

5700  
1/2 ROUND

**5500 FIXED**

72" X 72" MAX. CERTIFIED R.O  
12 3/4" X 12 3/4" MIN. R.O

**5700 1/2 ROUND FIXED**

72" X 36" MAX. R.O  
24" X 12" MIN. RO.

**5300 CASEMENT**

36" X 72" MAX. CERTIFIED RO.  
15 3/4" X 21 3/4" MIN. RO. W/ROTO HARDWARE    13 1/4" X 21 3/4" MIN. RO. W/PUSH/PULL HARDWARE

**5200 HOPPER**

61 1/2" X 33 1/2" MAX. CERTIFIED, MAX. NOT CERTIFIED RO. 60" X 36" OR 47" X 45"  
13 1/4" X 13 1/4" MIN. RO.

**5100 AWNING**

61 1/2" X 33 1/2" MAX. CERTIFIED, MAX. NOT CERTIFIED RO. 60" X 36" OR 47" X 45"  
21 3/4" X 17 1/2" MIN. R.O W/ROTO HARWARE    13 1/4" X 17 1/2" MIN. RO. W/PUSH/PULL HARWARE

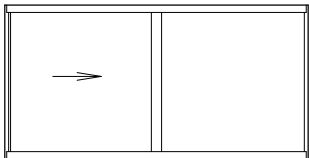

5000 2-LITE SLIDER

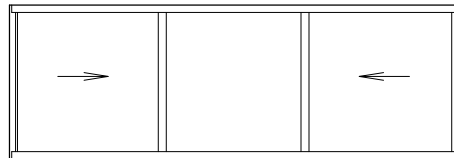

5000 3-EQUAL LITE SLIDER

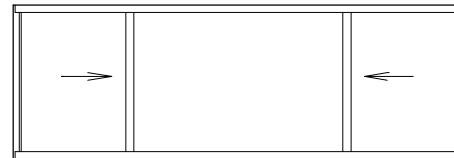

5000 3-LITE PICTURE SLIDER

**ALUMINUM 2-LITE SLIDERS**

C-30 96" X 72" MAX. CERTIFIED R.O, MAX NOT CERTIFIED 104" X 64"  
C-45 96" X 64" MAX. CERTIFIED R.O, MAX NOT CERTIFIED 96" X 72"  
18 3/4" X 12 3/4" MIN R.O

**ALUMINUM 3- EQUAL LITE SLIDERS**

C-30 156" X 72" MAX. CERTIFIED R.O  
C-45 156" X 64" MAX. CERTIFIED R.O  
C-45 156" X 72" MAX. NOT CERTIFIED R.O

**ALUMINUM 3-LITE PICTURE SLIDERS**

C-30 104" X 72" MAX. CERTIFIED R.O, 120" X 72" OR 132" X 60" MAX. NOT CERTIFIED  
C-45 104" X 64" MAX. CERTIFIED R.O, 120" X 72" OR 132" X 60" MAX. NOT CERTIFIED

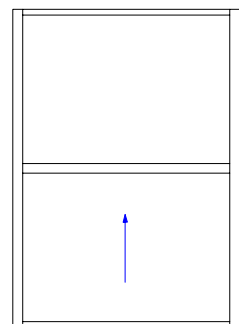

**5900 SINGLEHUNG**

54" X 90" MAX. CERTIFIED R.O  
16 1/2" X 30" MIN R.O

5900 SINGLEHUNG



# One frame window with multiple configurations

## Awning , Casement, Fixed & Hoppers



Gerkin Aluminum thermally broken commercial windows with 2 3/8" frame depth. Can be glazed with 5/8" or 1" units. Standard colors available: clear anodized, dark bronze anodized, white painted or bronze painted. Custom colors are available upon request.

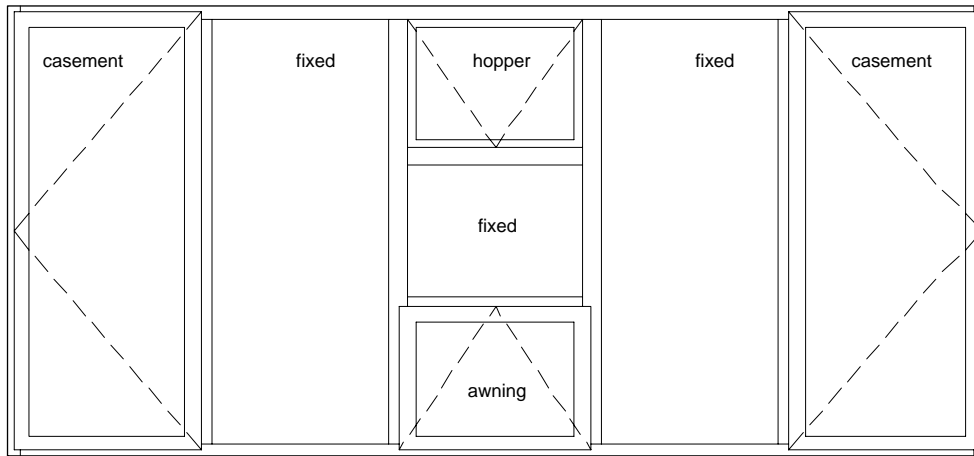

There are many different configurations that can be used in the Gerkin stand alone system. When choosing your configuration you must use the following guidelines.

### 1. The rails can not be crossed in a 1 frame configuration

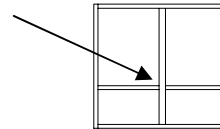

### 2. Maximum rough opening can not exceed 144" width X 72" height or 72" width X 144" height

### 3. Reference dimensions must conform to the following:

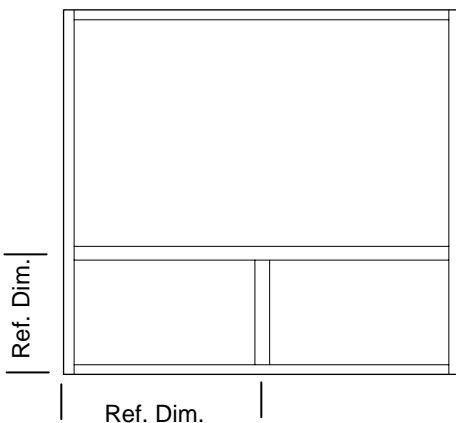

	max size	min size roto	min size push / pull
5100 Awning	60" x 30"	21" x 17 1/2"	12 1/2" x 17 1/2"
5200 Hopper	60" x 30"	N/A	12 1/2" X 12 1/2"
5300 Casement	36" x 72"	15" x 21 3/4"	12 1/2" x 21 3/4"
5500 Fixed	48" x 72"	N/A	12 1/2" x 12 1/2"

# Side-stack configurations with no structural mull

## Awning , Casement, Fixed & Hoppers

Gerkin Aluminum thermally broken commercial windows with 2 3/8" frame depth. Can be glazed with 5/8" or 1" units. Standard colors available: clear anodized, dark bronze anodized, white painted or bronze painted. Custom colors are available upon request.

### Caulk interior & exterior leg of stack rail

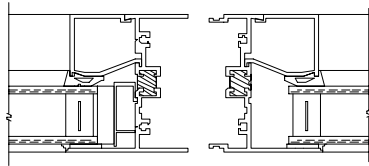

Stacking detail

(A)

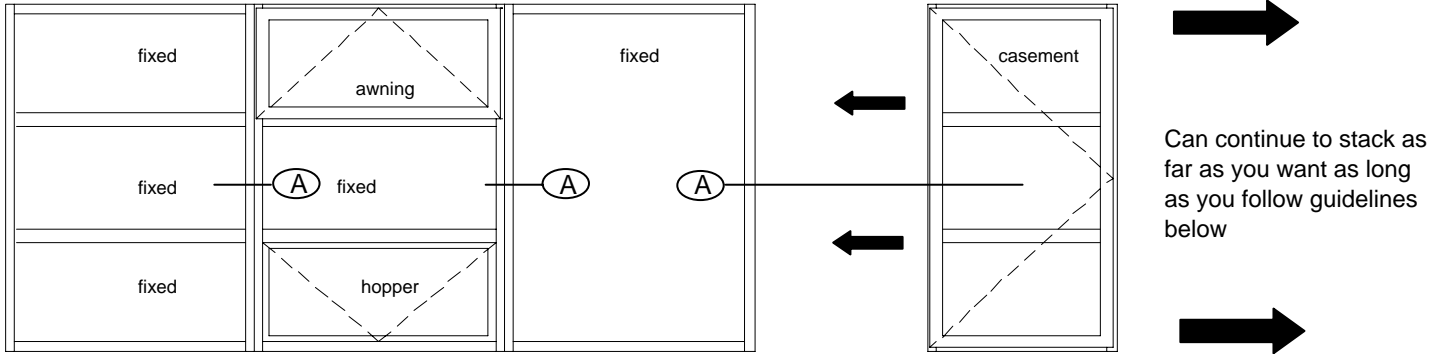

There are many different configurations that can be used in the Gerkin side stack system. When choosing your configuration you must use the following guidelines.

### 1. The rails can not be crossed in a 1 frame configuration

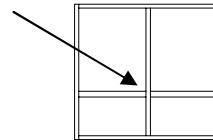

### 2. Individual frame cannot exceed 48" wide X 72" tall

### 3. Reference dimension must conform to the following:

	max size	min size roto	min size push / pull
5100 Awning	48" x 30"	21" x 17 1/2"	12 1/2" x 17 1/2"
5200 Hopper	48" x 30"	N/A	12 1/2" x 12 1/2"
5300 Casement	36" x 72"	15" x 21 3/4"	12 1/2" x 21 3/4"
5500 Fixed	48" x 72"	N/A	12 1/2" x 12 1/2"



## Side-stack configurations with stacking H channel

### Rhino sliding windows

Gerkin Aluminum thermally broken commercial windows. 2 3/8" frame depth. 5/8" overall insulated glass. Standard colors available clear anodized, dark bronze anodized, white painted or bronze painted. Custom colors are available upon request.

Caulk full perimeter interior & exterior of H channel

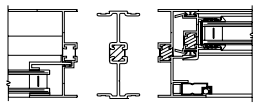

(A) Stacking H channel detail

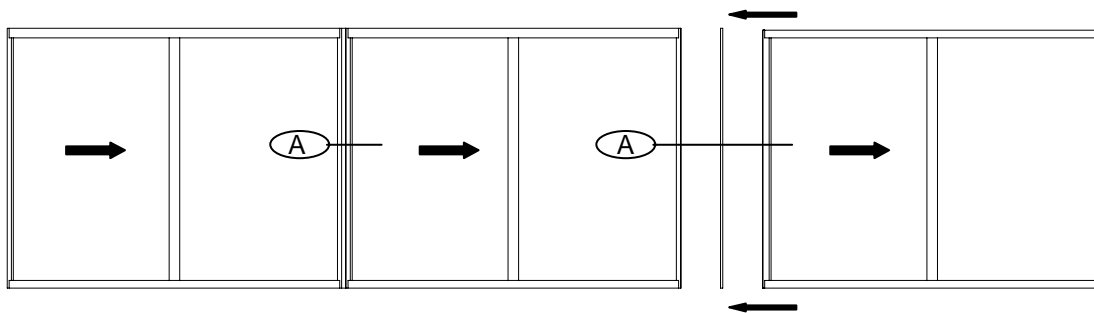

Can continue to stack as long as an individual slider does not exceed 72" wide X 72" tall.

## Side stack configurations with structural mullions

### Rhino sliding windows

Caulk full perimeter interior & exterior of structural mullion

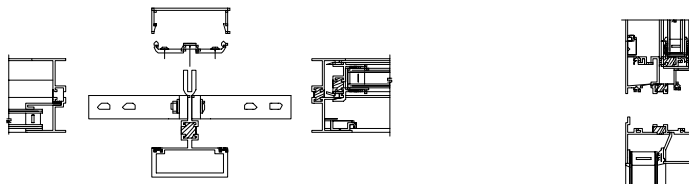

(B) Structural mullion detail

(C) Head stack detail

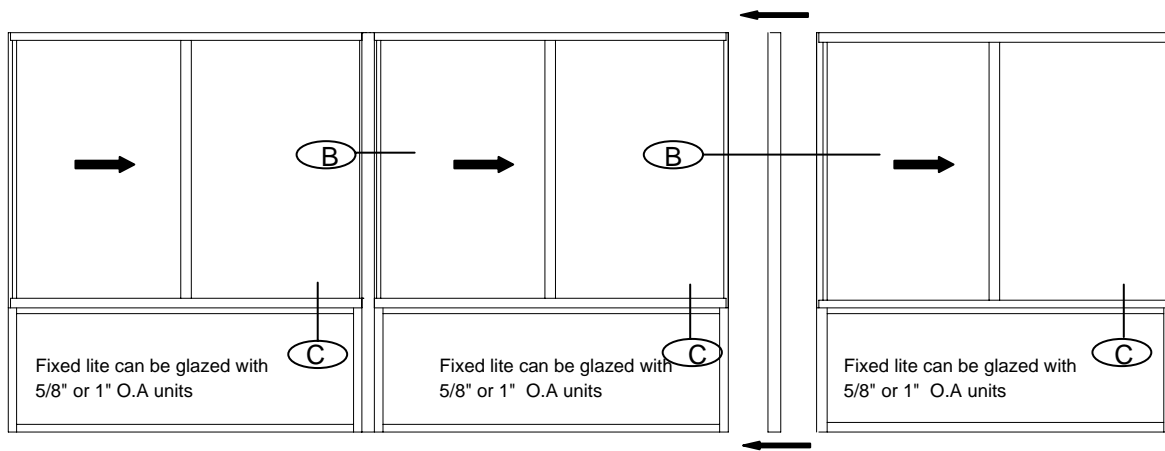

Can continue to stack as long as slider-fixed, head/sill stacked combination does not exceed 48" wide X 96" tall

# Head & sill stack configurations

## Rhino sliding windows

Gerkin Aluminum thermally broken commercial windows with 2 3/8" frame depth. 5/8" overall insulated glass. Standard colors available clear anodized, dark bronze anodized, white painted or bronze painted. Custom colors are available upon request.

**Caulk full perimeter interior & exterior of stack rails**

Head stack detail

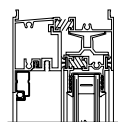
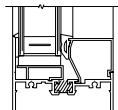

A

Head stack detail

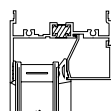
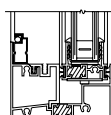

C

Head stack detail

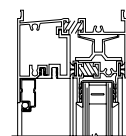
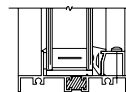

B

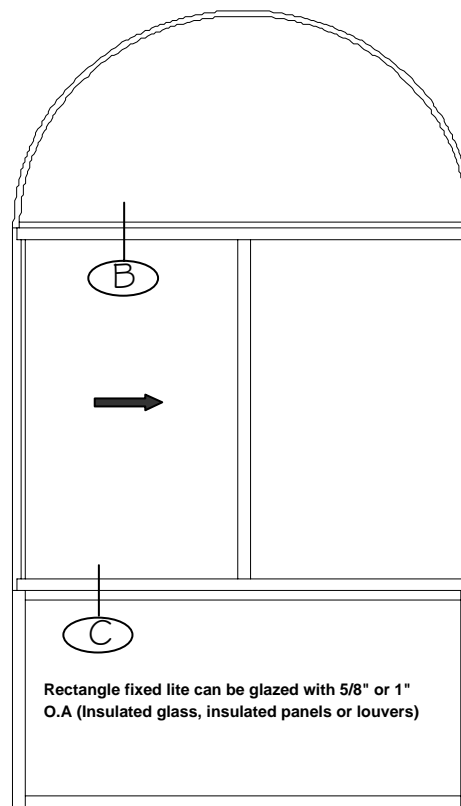
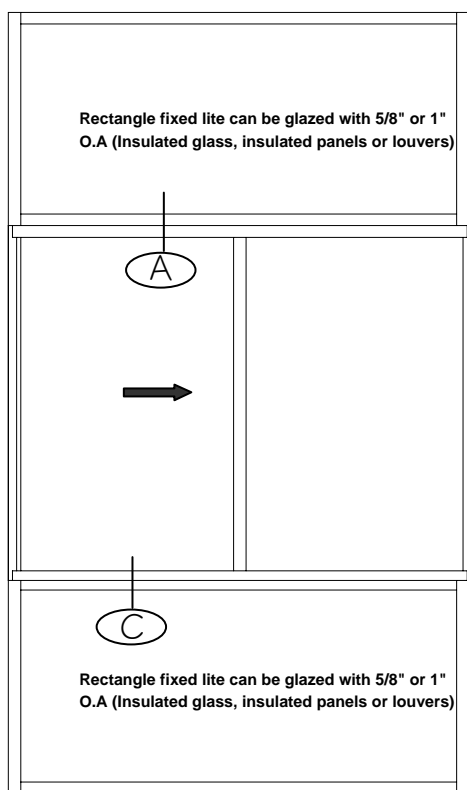

- Slider can not exceed 72" wide X 60" tall max.R.O
- Slider can not be below 18 1/2" wide X 12 1/2" tall min. R.O
- Transom can not exceed 72" wide X 36" tall max. R.O
- Transom can not be below 18 1/2" wide X 12 1/2" tall min. R.O
- Bottom fixed can not exceed 72" wide X 36" tall min. R.O
- Bottom fixed can not be below 18 1/2" wide X 12 1/2" tall min. R.O

- Slider can not exceed 72" wide X 60" tall max.R.O
- Slider can not be below 36" wide X 12 1/2" tall min. R.O
- 1/2 Round can not exceed 72" wide max. R.O
- 1/2 Round can not be below 36" wide min. R.O
- Bottom fixed can not exceed 72" wide X 36" tall min. R.O
- Bottom fixed can not be below 18 1/2" wide X 12 1/2" tall min. R.O

# Side-stack configurations with stacking H channel

## Rhino singlehung windows

Gerkin Aluminum thermally broken commercial windows. 2 3/8" frame depth. 5/8" overall insulated glass. Standard colors available clear anodized, dark bronze anodized, white painted or bronze painted. Custom colors are available upon request.

Caulk full perimeter interior & exterior of H channel

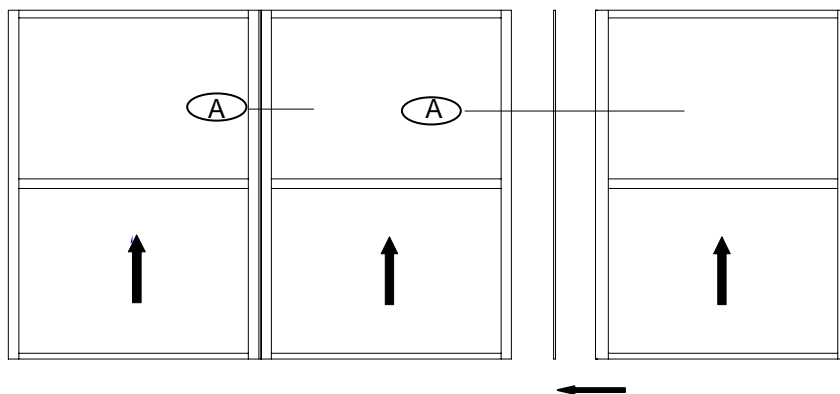
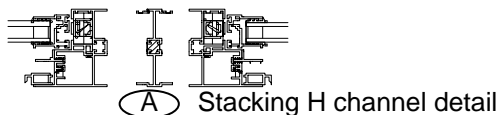

Can continue to stack as long as an individual singlehung does not exceed 48" wide X 72" tall.

# Side stack configurations with structural mullions

## Rhino singlehung windows

Caulk full perimeter interior & exterior of structural mullion

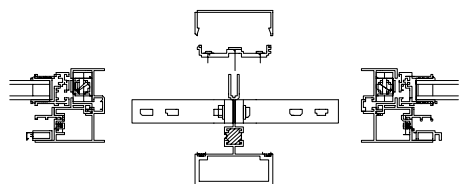

(B) Structural mullion detail

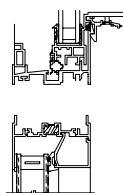

(C) Head stack detail

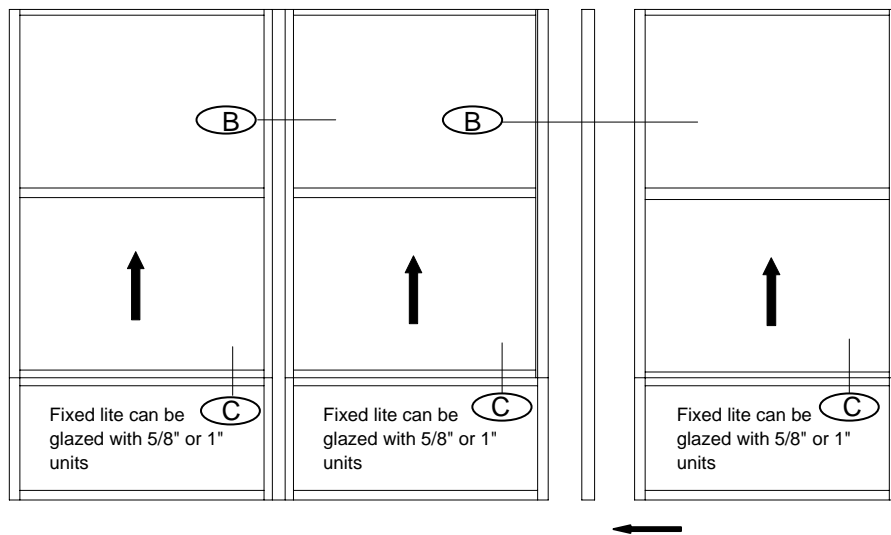

Can continue to stack as long as singlehung-fixed, head/sill stacked combination does not exceed 48" wide X 96" tall Or 36" wide X 120" tall

# Head & sill stack configurations

## Rhino singlehung windows

Gerkin Aluminum thermally broken commercial windows with 2 3/8" frame depth. 5/8" overall insulated glass. Standard colors available clear anodized, dark bronze anodized, white painted or bronze painted. Custom colors are available upon request.



**Caulk full perimeter interior & exterior of stack rails**

Head stack detail

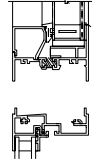

A

Head stack detail

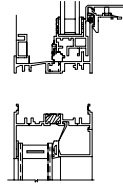

C

Head stack detail

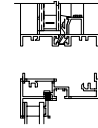

B

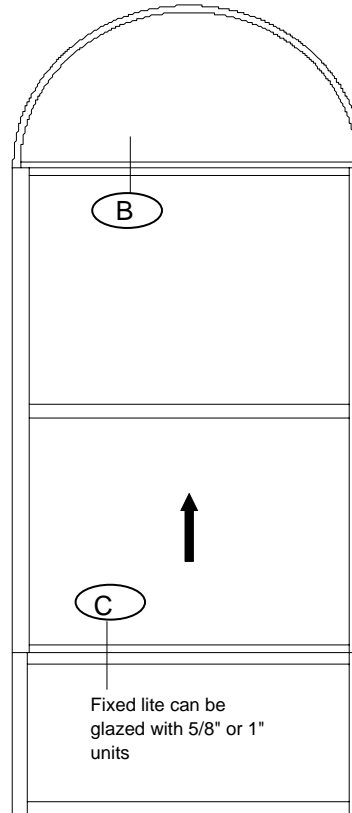
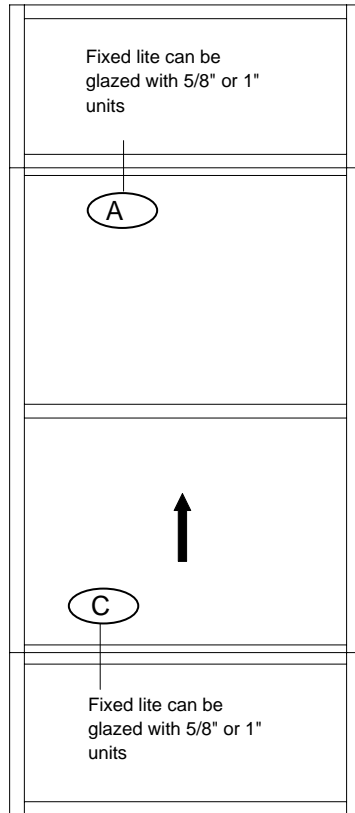

Overall unit cannot exceed 48" x 108"

- Singlehung can not exceed 48" wide X 72" tall max.R.O
- Singlehung can not be below 16 1/2" wide X 30" tall min. R.O
- Transom can not exceed 48" wide X 36" tall max. R.O
- Transom can not be below 18 1/2" wide X 12 1/2" tall min. R.O
- Bottom fixed can not exceed 48" wide X 36" tall min. R.O
- Bottom fixed can not be below 18 1/2" wide X 12 1/2" tall min. R.O

- Singlehung can not exceed 48" wide X 72" tall max.R.O
- Singlehung can not be below 16 1/2" wide X 30" tall min. R.O
- 1/2 Round can not exceed 48" wide max. R.O
- 1/2 Round can not be below 24" wide min. R.O
- Bottom fixed can not exceed 48" wide X 36" tall min. R.O
- Bottom fixed can not be below 18 1/2" wide X 12 1/2" tall min. R.O



**caulk full perimeter**

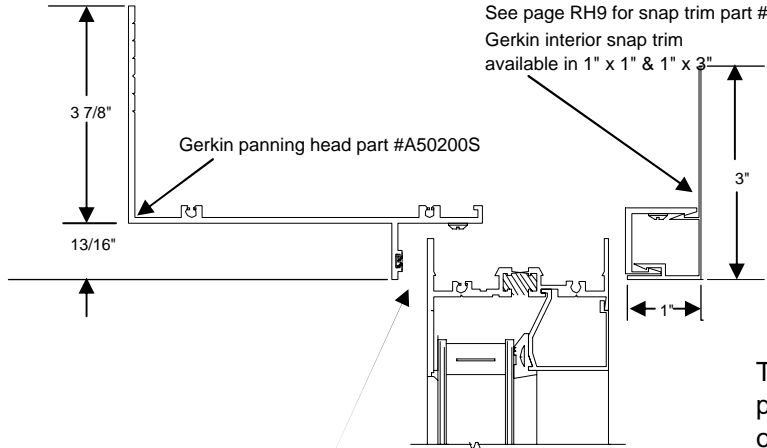

The Gerkin panning system is ideal for retrofit projects where you can't remove existing frames or there is some irregularities in the opening. The panning system is designed to cover unsightly conditions. On some projects panning can save labor when replacing old inefficient unsightly windows with thermally broken energy efficient windows that have a new and clean look. When using the panning system check out our interior snap trims that can be adapted to many conditions and will give you a nice finished look both interior and exterior.

**caulk full perimeter**

Vinyl bulb is for tolerance only, it is not a weather stripping.  
(Caulk full perimeter)

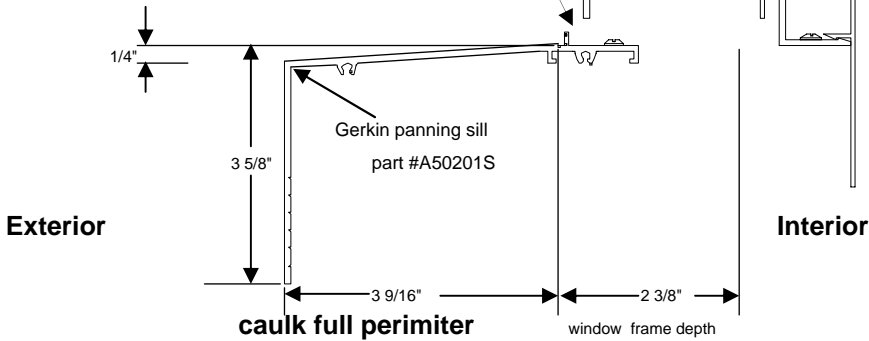

**caulk full perimeter**

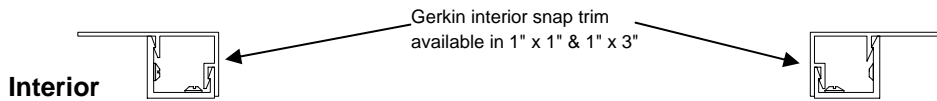

**caulk full perimeter**

vinyl bulb part #V50350BK

Vinyl bulb is for tolerance only, it is not a weather stripping.  
(Caulk full perimeter)

Gerkin panning jambs same as head

Gerkin panning jambs same as head

**caulk full perimeter**

**caulk full perimeter**

**Exterior**

# RHINO SERIES SUBFRAME SYSTEM



The Gerkin subframe system is ideal for new construction or retrofit projects where you don't want to set up bulky scaffolding or rent expensive lifts for window installations. The subframe is a two piece receptor system that is thermally broken and allows you to install windows from the interior of the building. When used the subframe system can save both time and money

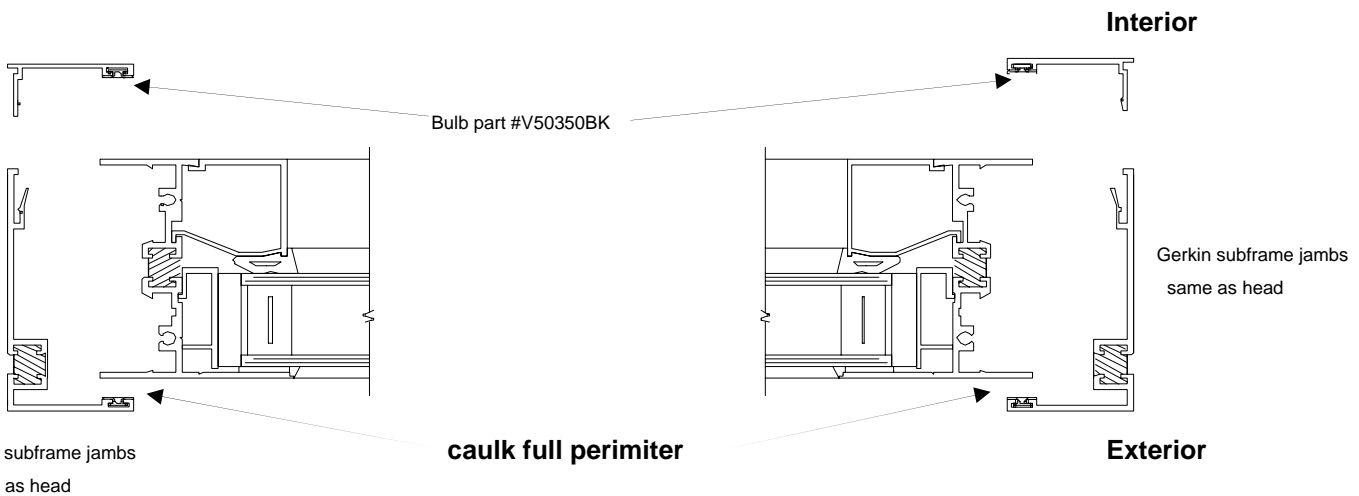
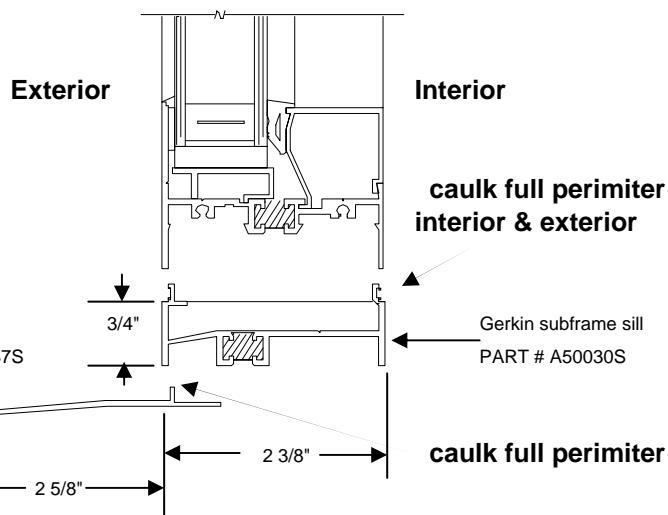
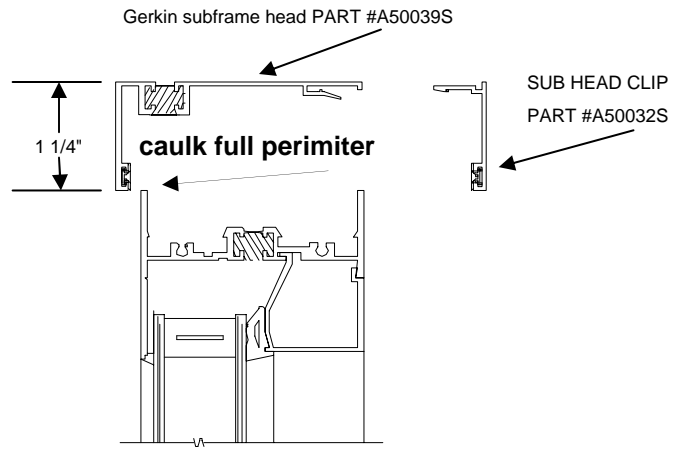



# RHINO SERIES ACCESSORIES



## GERKIN STRUCTURAL MULLION

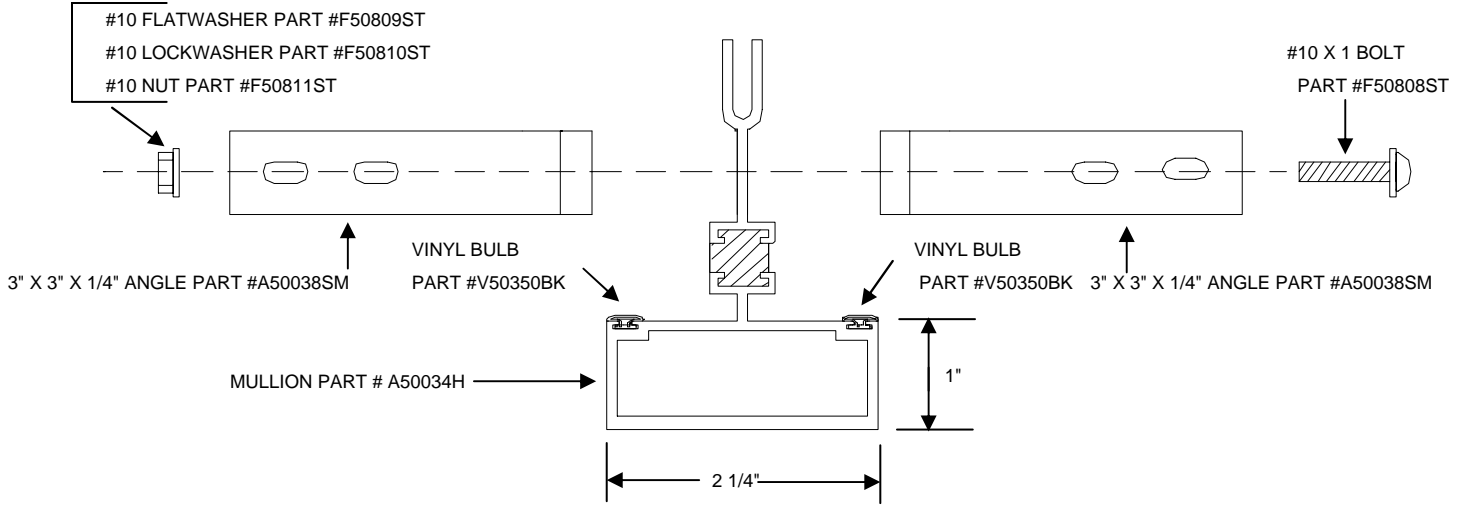
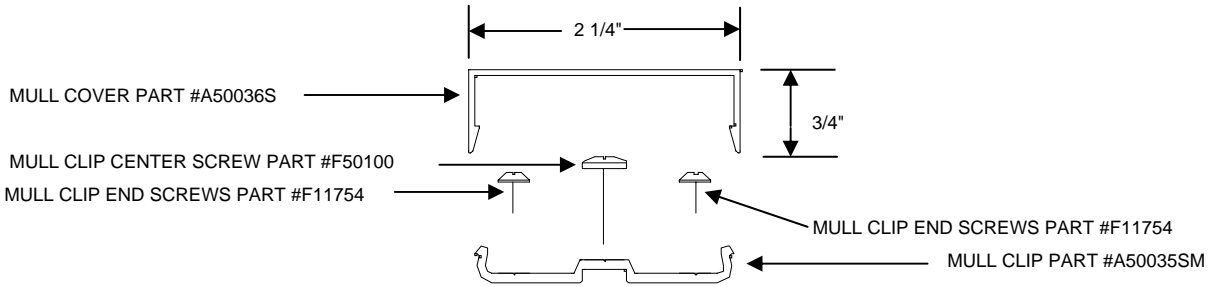

### GERKIN SILL FLASHING

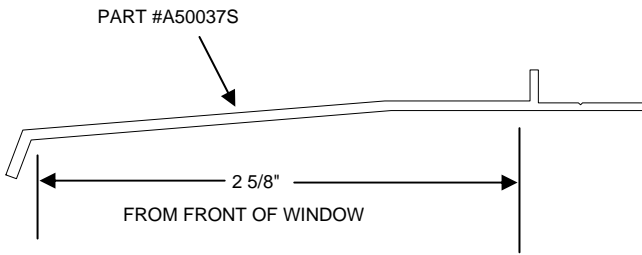

### GERKIN STACKING H CHANNEL

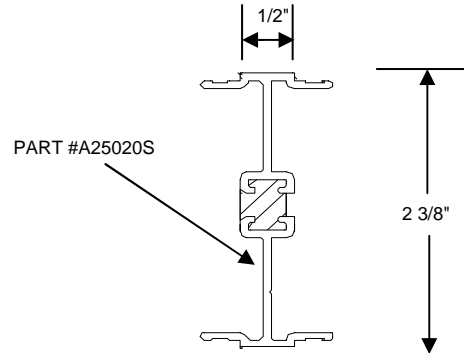

### GERKIN INTERIOR SNAP TRIM 1" X 1" OR 1" X 3"

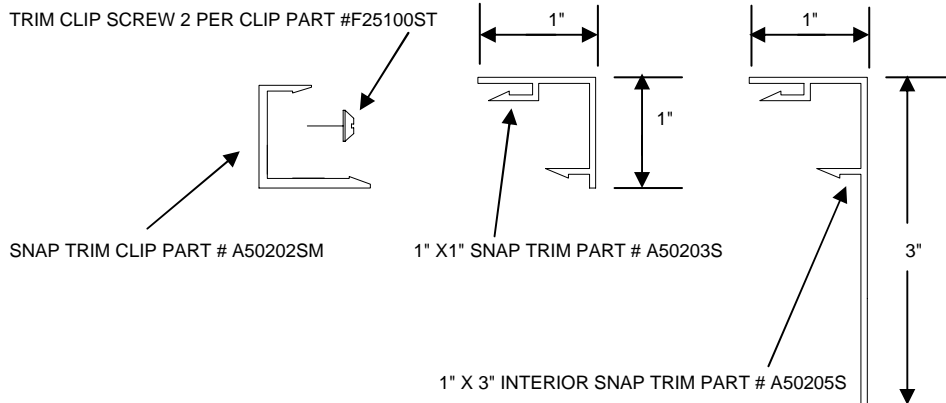



## LIMITED WARRANTY

This limited Warranty applies to window products manufactured by Gerkin Windows & Doors, So Sioux City, NE.

Gerkin Windows & Doors warrants its product to be free from defects in material and workmanship for a period five years from the date of original purchase. This warranty extends only to the original purchaser of the product, is limited to repair or replacement of defective parts. Hardware warranty is limited to repair or replacement of defective parts for a period of two years. This warranty is subject to the following conditions. Electric hardware is warranted for 1 year.

1. Hermetic seal of insulated glass shall be free from failure except breakage for a period of ten (10) years from the date of original purchase.
2. This warranty does not apply to broken or torn screens.
3. This warranty does not apply to any product which:
  - A. Has been improperly installed.
  - B. Has been repaired or altered outside Gerkin's plant as, in Gerkin's judgment, to impair its operation.
  - C. Has been subjected to misuse, negligent handling, or accident.
  - D. Has product damage caused by building shift or shrinkage.
4. Gerkin is not responsible and will not be held liable for special indirect, or consequent damage, including injury or damage caused to person or property by reason of the failure, installation, use, or operation of any product. Some states do not allow for the exclusion or limitation of incidental or consequential damages so this condition may not apply to you.
5. It is the policy of Gerkin Windows & Doors to constantly strive to improve its products. The right therefore is reserved to make changes in design and improvements whenever it is believed the efficiency of the product will be improved thereby, but without incurring any obligation to incorporate such improvements in product which has been shipped or is in service.
6. Implied warranties are limited in operation to five years from date of purchase. Some states do not allow limitations on how long an implied warranty lasts, so this limitation may not apply to you. This warranty gives you specific legal rights and you may have other rights which vary from state to state.

If you believe that product is defective in material or workmanship the following actions must be taken

1. Telephone (402) 494 -6000 or fax (402) 494 -6765 and advise Gerkin of the nature of the problem. Should an inspection be needed, it will be made promptly after your initial notification by an authorized representative of Gerkin Windows & Doors.
2. If the authorized representative determines the product to be defective and covered by warranty, arrangements will be made to correct the problem. If the authorized representative determines that the problem is not covered by warranty, you will be notified and arrangements can be discussed for correction of the problem.
3. If you are not satisfied with the service the authorized representative has performed in any respect, you must notify Gerkin in writing of the reason you are not satisfied within ninety (90) days after your initial notification of the claimed defect. If Gerkin feels your complaint is justified, we will work with the product purchaser until both parties are satisfied and the claimed defect is corrected.